

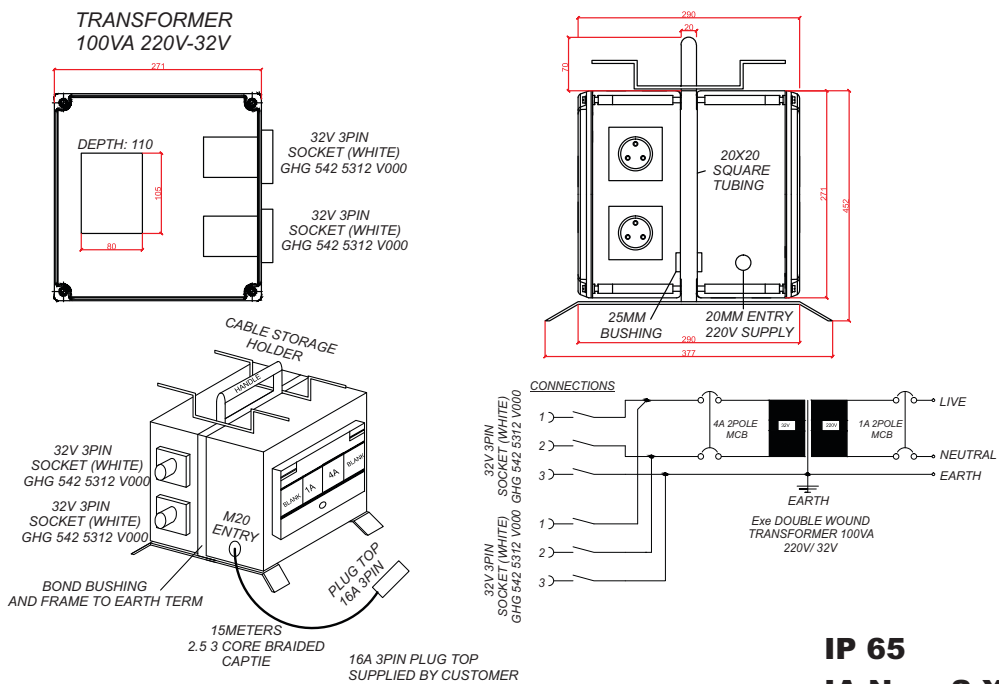

The step down transformer is a double wound, 230-32v transformer with circuit breaker protection which can be easily reset under a flap in a hazardous area. Suitable for use in zone 1 and 2 areas, with 2x 32v socket outlets.

Applications: Boiler inspection where low voltage is a safety requirement.



IP 65

IA No. - S-XPL/04072x



Electric (Pty) Ltd.
EXPLOSION PROTECTED EQUIPMENT

